

DRAWER & DOOR ADJUSTMENTS

Once the unit is installed and levelled, proceed as follows:

- Insert the drawers and the doors
- Adjust the front panels
- Fit the finishing covers
- Recheck the adjustments once the drawers are loaded

DRAWER ADJUSTMENTS

REMOVE THE DRAWERS



- Open the drawer and press the grey tabs



- Lift and pull to remove the drawer



Advice :
Use shims to leave the unit on the floor

INSTALL THE DRAWERS



- Insert the drawer slides



- Push the drawer in until it clicks into place

ADJUST THE DRAWERS



- Unclip the drawer cover

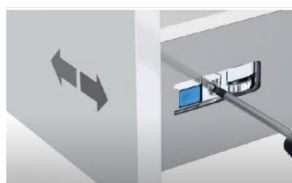

- For lateral adjustment of +/- 1.5 mm

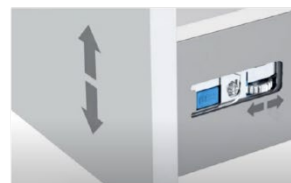

- For height adjustment of +/- 2 mm

DRAWER & DOOR ADJUSTMENTS

ADJUST THE DRAWERS

Adjustment applicable when the drawer has side panels

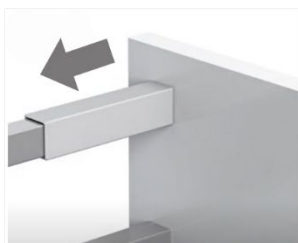

- Remove the cover

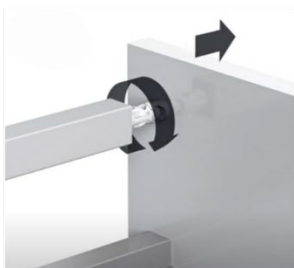

- Using a screwdriver, move the front panel forward

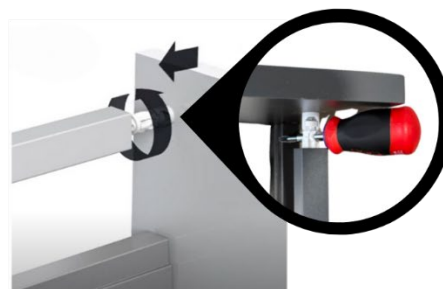

- Using a screwdriver, move the front panel backward

DISENGAGE A FRONT PANEL



- Press the blue button located on each side of the drawer simultaneously, then lift the drawer.

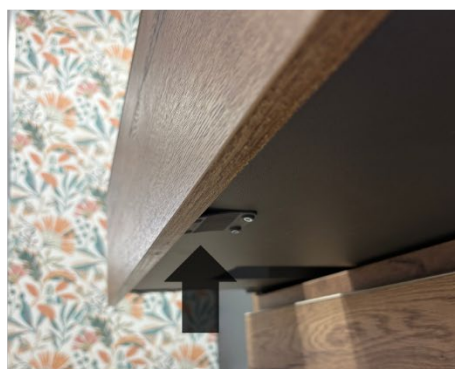

- Drawers wider than 80 cm are equipped with a stabilizer.
- Unscrew this stabilizer before disengaging the front panel.

DOOR ADJUSTMENTS

DRAWER & DOOR ADJUSTMENTS

DISASSEMBLY

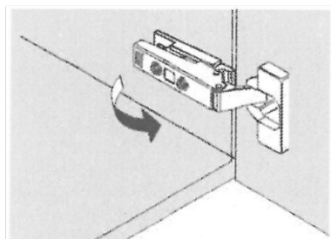

- Grab the hinge by the rear flap and pull it forward (Never disassemble the hinge base).

ASSEMBLY

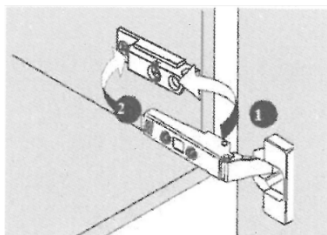

- Insert (1), fold down and snap into place (2).

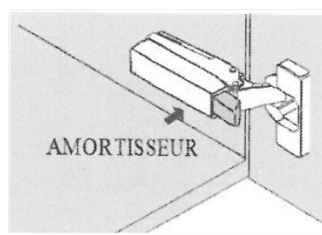

- After adjustment, place one damper per door, not one per hinge.
- Place the covers on the other hinges.

ADJUSTMENT

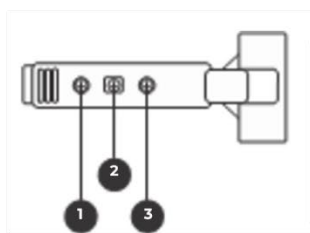

- Each hinge has 3 adjustment screws

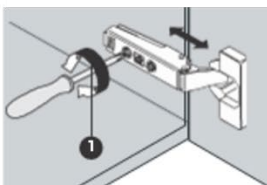

- 1 : Depth adjustment

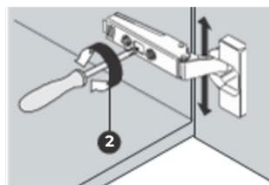

- 2 : Height adjustment

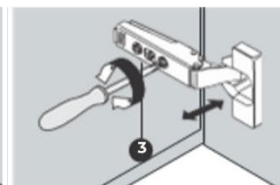

- 3 : Lateral adjustment